



**MacDermid
Design Ltd**

A FULL SERVICE METAL FABRICATION COMPANY

 www.macdesignltd.com

2650 E. Mohawk Lane, Suite 152, Phoenix, Arizona 85050
Phone: 602-482-7215 Email: info@macdesignltd.com

VEHICLE APPLICATION

<ul style="list-style-type: none">2024-2026	<ul style="list-style-type: none">Can-Am Maverick RCan-Am Maverick R 4
---	---

HARDWARE INCLUDED

(4) M6 x 50mm Flange Bolt	(4) Aluminum Washer
(2) M8 x 80mm Flange Bolt	(2) M8 Steel Nylon-Insert Flange Locknut
(5) M8 x 16mm Steel Flanged Bolt	(5) M8 Steel Serrated Flange Locknut
(1) M6-1 x 20mm Flange Bolt	(1) M6 Steel Nylon-Insert Flange Locknut
(1) Abrasion-Resistant Cushioning Washer	(4) Tie Down Rings
(2) Keys For Lockable Latches	

TOOL LIST

<ul style="list-style-type: none">10mm Socket & Wrench	<ul style="list-style-type: none">13mm Socket & Wrench
<ul style="list-style-type: none">5/16" Drill Bit Or Larger	<ul style="list-style-type: none">Drill

INSTALLATION NOTES

***READ ALL INSTRUCTIONS FROM START TO FINISH BEFORE BEGINNING INSTALLATION.
FAILURE TO DO SO MAY RESULT IN DAMAGE TO PRODUCT***

***LID OF STORAGE BOX IS SPRING LOADED FOR AN ADDITIONAL 75LBS. DO NOT OPEN LID
UNLOADED WITHOUT APPLYING DOWNWARD FORCE TO TOP TO PREVENT INJURY***

*** MACDERMID DESIGN IS NOT RESPONSIBLE FOR ANY DAMAGE OR FAILURE RESULTING
FROM IMPROPER INSTALLATION***

DISCLAIMER

This product is warrantied against manufacturer defects only. Any claim against a defect must
be made within 7 days of receipt. Please visit our website
www.macdesignltd.com/return-policy for more information.

ITEM NO.	PART NUMBER	DESCRIPTION	QTY.
1	430-ST5B-R2-DIVIDER	DIVIDER	4
2	92461A400	M8 Steel Nylon-Insert Flange Locknut	2
3	96194A102	M8 Steel Serrated Flange Locknut	5
4	94036A416	M8 x 16 Steel Flanged Hex Head Screw 8.8	5
5	BFD6X50YLW	M6 x 50 FLANGE BOLT 10.9	4
6	BFD8X80YLW	M8 x 80 FLANGE BOLT 10.9	2
7	1.5 x 080 AL WASHER	ALUMINUM WASHER	4
8	90131A305	Abrasion-Resistant Cushioning Washer	1
9	92461A300	M6 - Steel Nylon-Insert Flange Locknut	1
10	95735A221	M6-1 x 20 JIS FLANGE BOLT	1
11	39695T51	TIE DOWN RING	4

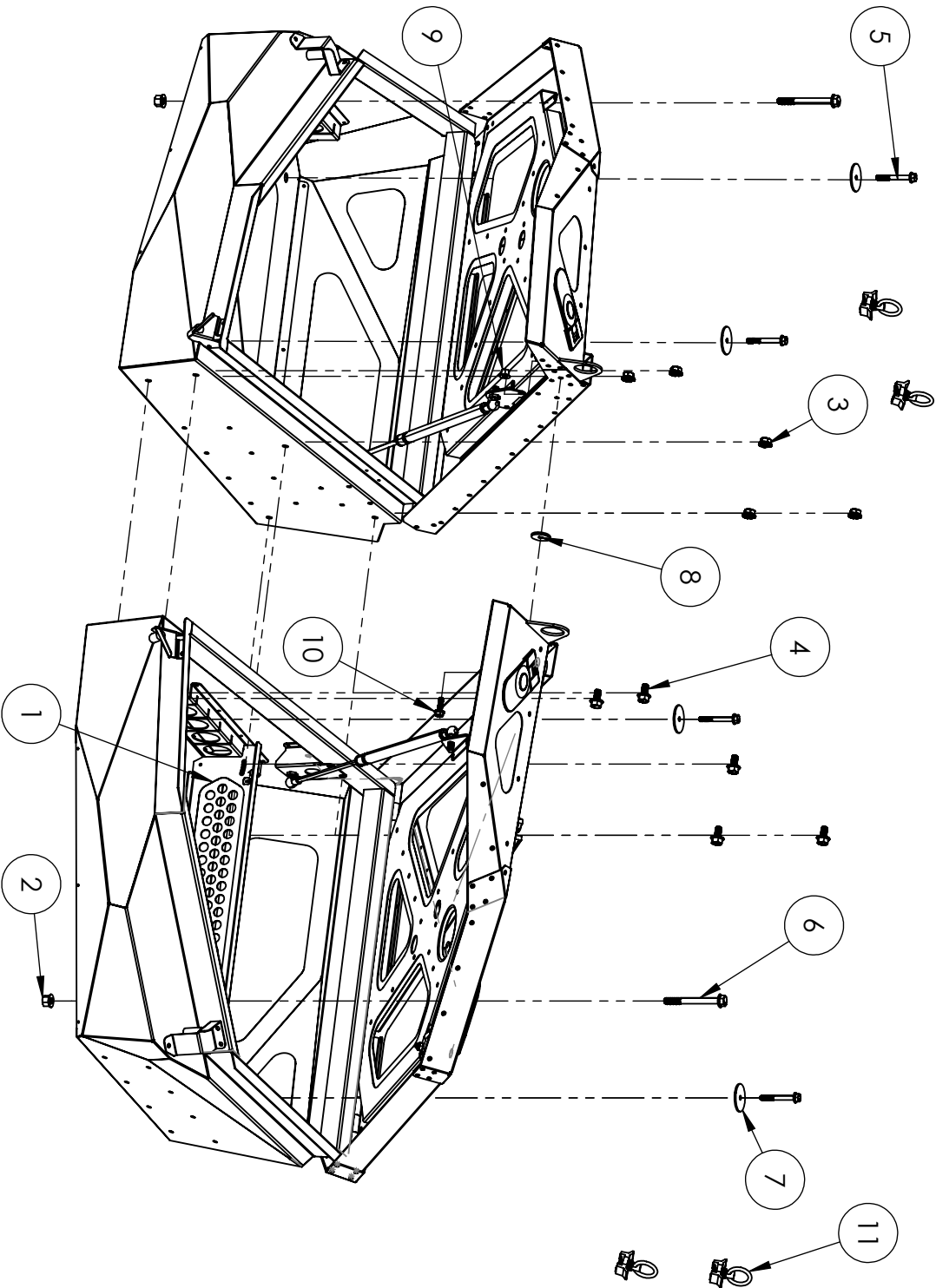

INSTALLATION

1. First, if the Linq mounting system is installed, remove the brackets from the bed as well as any side covers to the cubbies off to either side. Then clear any dust and debris from inside the bed. (Figure 1)

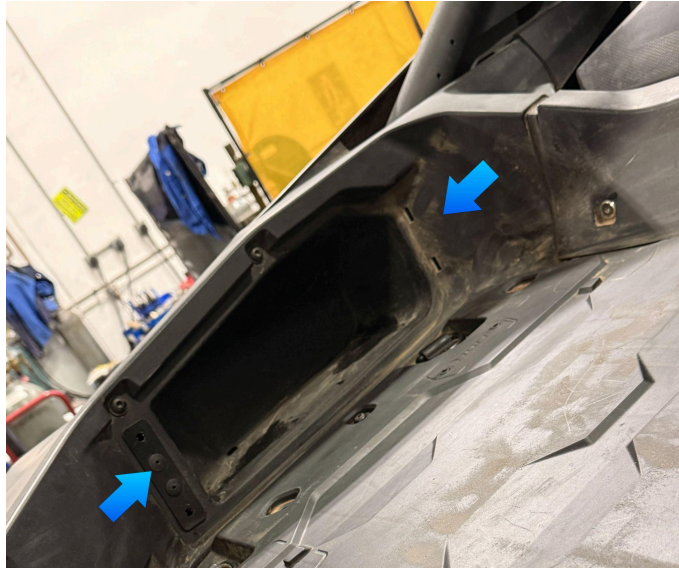

Figure 1

2. Next remove the bolts from all indicated holes and drill the plastic in the two front corners on both the left and the right side, shown in blue, using at least a 5/16th drill bit. If needed a slightly bigger drill bit can be used. We are increasing the size of the hole in the plastic to fit the larger M8 hardware we will be using. (Figure 2)

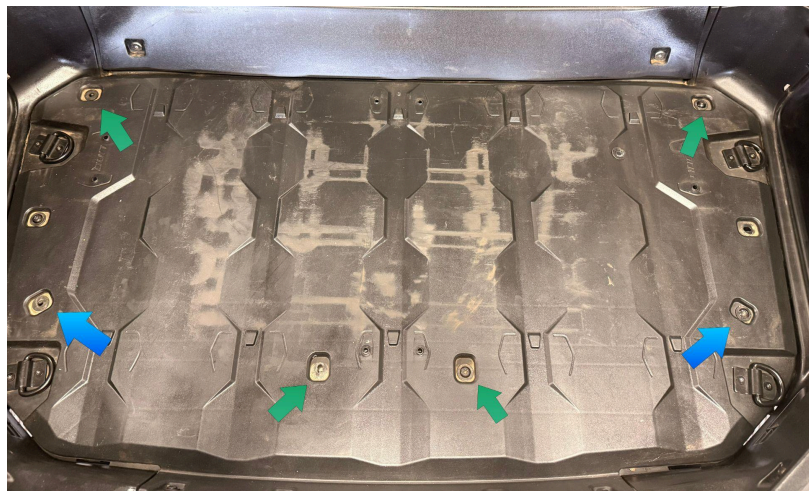

Figure 2

3. Now that the two outer holes have been drilled, grab one half of the storage box and place it into the bed followed by the other half.
4. The next step is to bolt the two halves of the lid together using the provided 20mm M6 bolt, M6 flange nut, and the cushioning washer using a 10mm wrench and socket. The washer will act as a spacer for the lids so to install pull one of the lids down, run the bolt through, put the washer in the middle of both lids, then raise it back up so it is in between the lids, then bolt the two together. (Figure 3, 4, and 5)



Figure 3



Figure 4



Figure 5

5. Now grab a 13mm wrench and socket and the provided 16mm M8 hardware so the two halves can be bolted together from the inside. There are five holes to use for these bolts. These will be easier to access with the divider panels removed. (Figure 6)

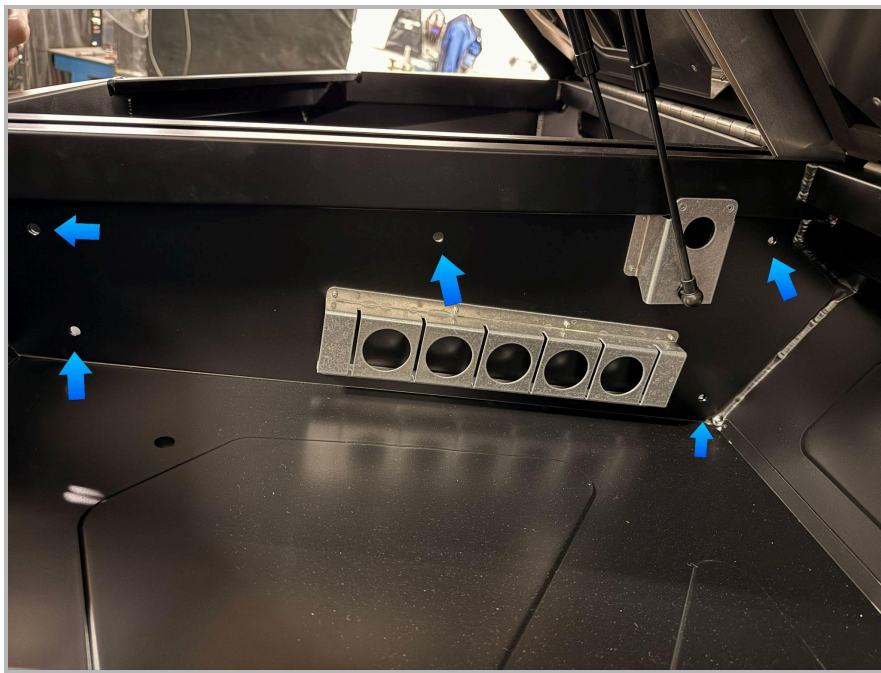

Figure 6

6. Once the halves of the box are attached we will bolt the box to the bed. Start with the two mount holes that we did not drill out, one in the center, and one in the far back corner on both sides. This will use the 50mm M6 flange bolts with the aluminum washers and a 10mm socket. (Figure 7)



Figure 7

7. The final step is to install the 80mm M8 bolts in the hole we drilled out. The M8 flange nut will be used on the underside of the bed which can be accessed through the wheel well of the vehicle. To install these we will be using a 13mm wrench and socket.(Figure 8)

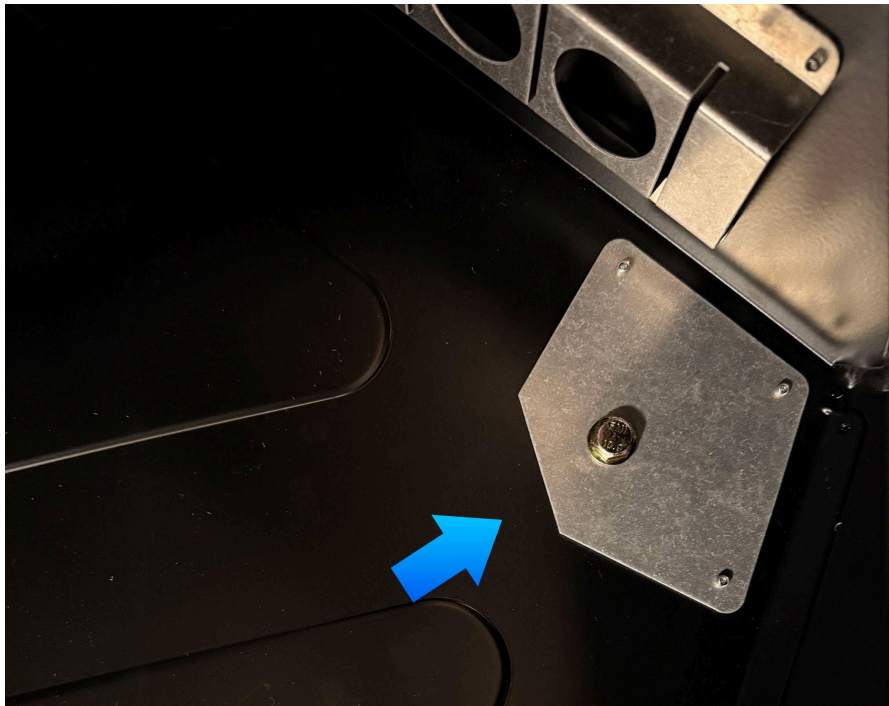

Figure 8

8. Now go out and enjoy your new Can-am Maverick R storage box and spare tire mount!